

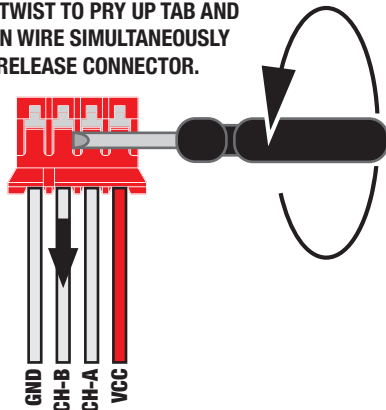

JDDX2R-SP RELOOP SPIN CONTACTLESS FADER FOR CHANNEL A (TURNTABLE) DOUBLE CUT

LIGHTLY TWIST TO PRY UP TAB AND
PULL ON WIRE SIMULTANEOUSLY
TO RELEASE CONNECTOR.



MOVE CH-B WIRE
OFF TO ONE SIDE.

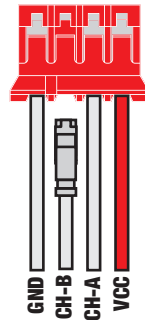

LIGHTLY TWIST TO PRY UP TAB AND
PULL ON WIRE SIMULTANEOUSLY
TO RELEASE CONNECTOR.

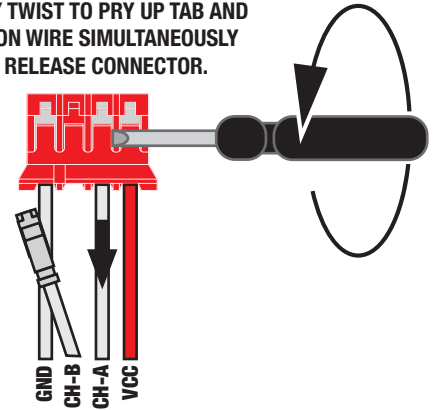

PLACE CH-A CONNECTOR IN
CH-B SOCKET AND PUSH IN.

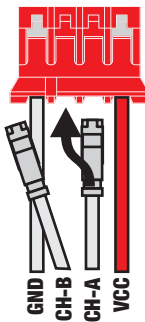

PLACE CH-B CONNECTOR IN
CH-A SOCKET AND PUSH IN.

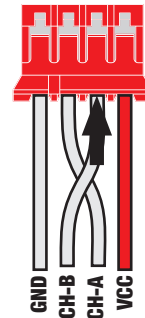

LIFT JUMPER OFF
2 CHANNEL CUT

MOVE JUMPER TO
DOUBLE CUT PINS

PRESS JUMPER ON
FOR DOUBLE CUT

